

WELCOME TO

6207 FINLAYSON DRIVE NORTH

\$429,000

6678

NATHAN ROUND

WORK 867.669.2103

CELL 867.446.2458



ROOM SIZES

Living Room 16.7 X 15	Dining 7.4 X 15	Kitchen 10.8 X 11.9			BATHS	1-4pc, 1-3pc Ensuite
Primary Bedroom 11.7 X 12.5	Bedroom 10.8 X 9.6	Bedroom 7.11 X 9.6			Storage	Basement
Laundry Room 5.2 X 8				Make: Triple E Model: Duplex A Serial #: 2562A	Foyer / Entry	Deck

HEAT

INSULATION

BUILDING

LOT

Type PROPANE	Ceiling: R Walls: R Floor: R Skirting: R	Sq. Ft. 1192	Age 1987	Lot Size 7952
Annual Cost Litres Over Last 12 Mo. 3792 L		Lot 72	Block 548	Garage Carpport
		Plan 4258	Unit	Parking Gravel Drive

SPECIAL FEATURES /FURNISHINGS:

Ample parking, room to run and no neighbors to the back! 6207 Finlayson Dr North is a 3 bedroom 2 bathroom semi-detached home situated on a massive 7952 square foot lot close to schools, shopping and backing onto Range Lake. This updated home has recently benefited from new kitchen counters, kitchen backsplash, Pex plumbing, duct cleaning and Paint + Hot water tank in 2023. Room to park an entire convoy out front and a massive, fully fenced yard with a storage shed and lake views in the back. Family friendly neighborhood only blocks from NJ Mcpherson & St Joes schools. High efficient propane furnace installed in 2012. Triple pane windows, Deck, Eavestroughs, Landscape, siding, front door all done in 2022/23. Call today for a private tour!

Price Includes: Dishwasher, Stove, Refrigerator, Microwave, Washer, Storage Shed, Dryer

FOUNDATION

Block

PROPERTY TAXES

Amount/yr	\$2847.96	2025
-----------	-----------	------

Tenure	Fee Simple
--------	------------

Fees

Area	FRAME LK SOUTH
------	----------------

6207 Finlayson Dr N, Yellowknife, NT

Main Floor Exterior Area 1192.96 sq ft
Interior Area 1068.59 sq ft

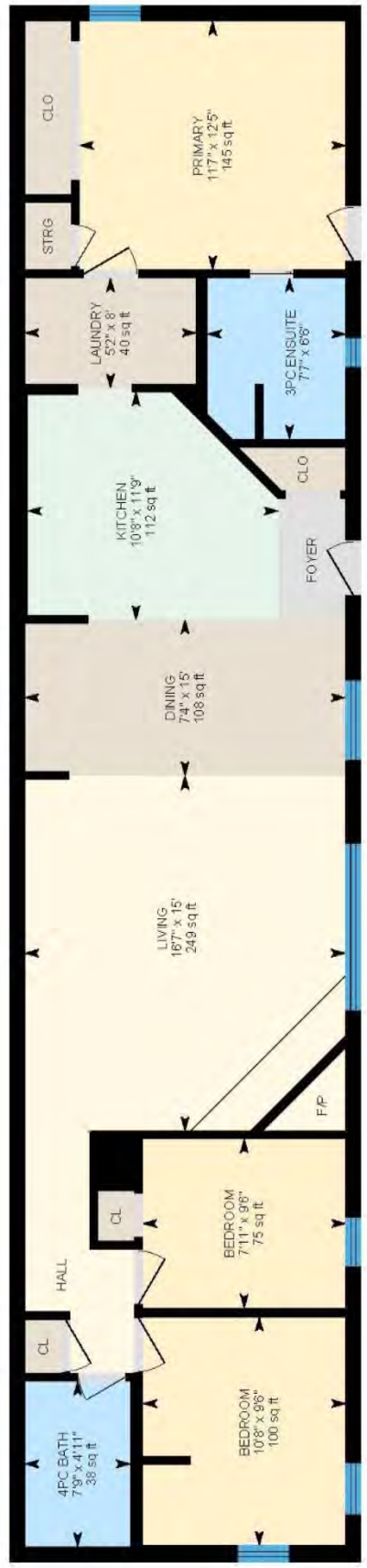

PREPARED: 2026/05/12



White regions are excluded from total floor area in iGUIDE floor plans. All room dimensions and floor areas must be considered approximate and are subject to independent verification.

